



M-7 RGBA

Stage Fog Machine

User Manual



© 2015 Antari Lighting and Effects Ltd.

M-7

ORGBA
STAGE FOGGER

User Manual

Safety Information



Please read the following safety information carefully before operating the machine. Information includes important safety information about installation, usage, and maintenance. Pay attention to all warning labels and instructions in this manual and printed on the machine.

If you have questions about how to operate the machine safely, please contact your local Antari dealer for help.

- Keep this device dry.
- Always connect to a grounded circuit to avoid risk of electrocution.
- Before connecting machine to power, always check voltage indicate on machine match to your local AC voltage. Do not use the machine if AC power voltage does not match.
- Disconnect the machine from AC power before servicing and when not in use.
- This product is for indoor use only! Do not expose to rain or moisture. If fluid is spilled, disconnect AC power and clean with a damp cloth. If fluid is spilled onto electronic parts, immediately unplug the machine and contact your local Antari dealer for advice.
- No user serviceable and modifiable parts inside. Never try to repair this product, unauthorized technician may lead machine to damage or malfunction.
- For adult use only. Never leave the machine running unattended.
- Installed in well ventilated area. Provide at least 50 cm space around the machine.
- Never add flammable liquid of any kind to the machine.
- Make sure there are no flammable materials close to the machine while operating.
- Only use Antari fluid. Other fluid may lead to heater clog and malfunction.
- If the machine fails to work, unplug the machine and stop operation immediately. Contact your local Antari dealer for advise.
- Before transporting the machine, make sure the fluid tank is completely drained.
- Smoke fluid may present health risks if swallowed. Do not drink smoke fluid. Store it securely. In case of eye contact or if fluid is swallowed immediately look for medical advice.

Unpacking and Inspection

Immediately upon receiving the machine, carefully unpack the carton, check all content to ensure that all parts are present and have been received in good condition. If any parts appear damaged or mishandled from shipping, notify the shipper immediately and retrain the packing material for inspection.

What is included:

- 1 x M-7 RGBA Fogger
- 1 x W-2 Wireless Remote
- 1 x Power Cord
- 1 x User Manual

Product Dimension



Product Overview

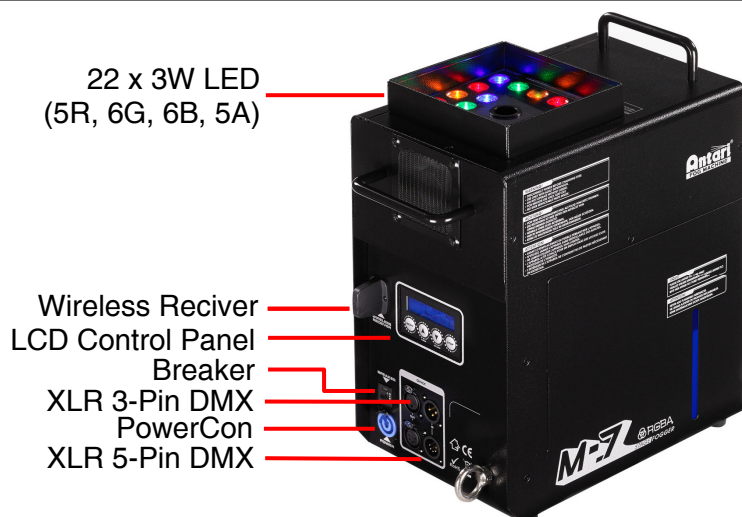

Setting Up

Step 1: Place the machine on a flat surface and in a suitable large area with at least 50 cm open space around the machine.

Step 2: Fill the fluid tank with Antari approved fluid.

Step 3: Connect the machine to suitable rated power supply. To determine the power requirement for the machine refer to the label on the back of the machine.



Always connect the machine to a protected circuit and ensure it is properly grounded to avoid risk of electrocution.

Step 4: Turn on the machine and allow it to heat up. Heat up takes approximately 5 minutes. Once the machine has reached operating temperature, the LCD display will show “Ready To Fog”. Now the machine is ready for operation.

Step 5: To start making fog, locate the **Volume** button on the control panel, and press the button to start making fog.

Step 6: To turn off the machine, press **STOP** button and turn Powercon to the **OFF** position.

Operation

Control Panel Operation

The machine can be operated with onboard digital control interface

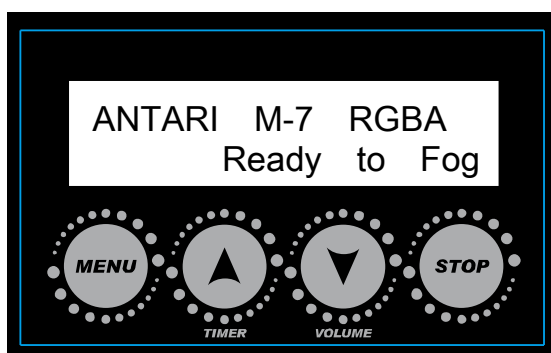

| Button | Function |
|-------------------|----------------------------------|
| [MENU] | Scroll through setting menu |
| ▲ [UP]/[TIMER] | Up/Activate Timer function |
| ▼ [DOWN]/[VOLUME] | Down/Activate Volume function |
| [STOP] | Deactivate Timer/Volume function |

Control Menu

| | |
|----------------------------------|---|
| DMX512 Address: 1 | Set DMX address from 1 to 504 |
| Stand Alone Set Master | Set machine as Master of Slave unit |
| Color Mode On | Turn LED On or Off |
| Color Mode Marco:01 | Set LED output color from macro 1 to 10 |
| Color Mode Chase:01 | Set LED chase from 1 to 15 |
| Timer Interval 15 Sec | Set interval from 15 to 360 seconds |
| Timer Duration 5 Sec | Set duration from 1 to 5 seconds |
| Wireless Setting On | Turn On or Off wireless control |
| Wireless Setting Button A:M01 | Set wireless remote button function macro color 1 to 10 or chase 1 to 15 and off. |

| | |
|----------------------------------|---|
| Wireless Setting Button B:M01 | Set wireless remote button function macro color 1 to 10 or chase 1 to 15 and off. |
| Wireless Setting Button C:M01 | Set wireless remote button function macro color 1 to 10 or chase 1 to 15 and off. |
| Wireless Setting Button D:M01 | Set wireless remote button function macro color 1 to 10 or chase 1 to 15 and off. |
| LED Setting Fog Only | Setting for LED to turn on with fog only or always on. |
| LED Fade Out Delay: 0 Sec | Set LED delay time from 0 to 5 seconds. |
| Run Last Setting On | Turn On/Off run last setting function |
| 2 Second Jet Mode off | Turn On/Off 2 Second Jet Mode |
| W-DMX Power Off | Turn On/Off W-DMX |
| W-DMX Reset Off | Rest W-DMX connection |

Wireless Operation

Wireless remote control system W-2 consist of a transmitter equipped with four buttons to activate four user configurable LED setting and fog; with an onboard receiver attach to the rear panel of M-7 RGBA.



W-2 Wireless Transmitter



Wireless Receiver

Wireless settings are configurable through onboard control panel, refer to control menu section to setup each buttons.

In a free open space the effective distance is 50 meters, actual usage depending on obstacle level the effective distance is 10-25 meters.

Registering transmitter

Transmitter can be pair or deleted from the receiver. Each receiver can pair up to 10 transmitters. Follow below steps to pair or delete transmitter from receiver.

Step 1: Power off M-7 RGBA Fogger

Step 2: Press and hold [DOWN] button

Step 3: Turn power on and release [DOWN] button when LCD display blinks

Step 4: Follow the menu instruction to pair or delete transmitter

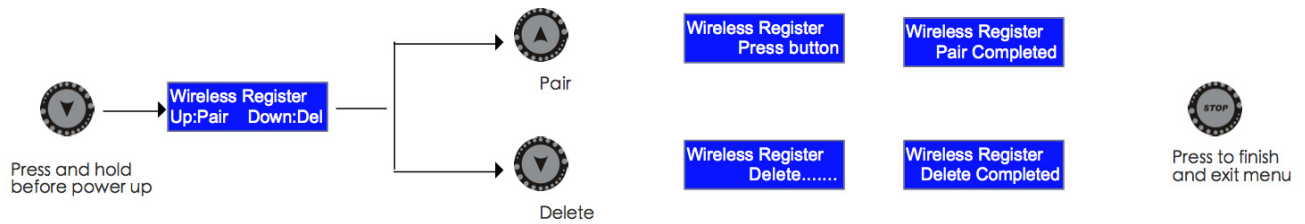

Transmitter battery replacement

If effective distance seems to be decreased, it is possible the battery level are low and require replacement. In order to replace the battery, undo the three screws on the back of transmitter to release the cover. Replace with same type and specification of battery which is 27A 12V

DMX Connector Pin Assignment

The machine provides 3 or 5 pin XLR connector for DMX connection. Diagram below indicate pin assignment information

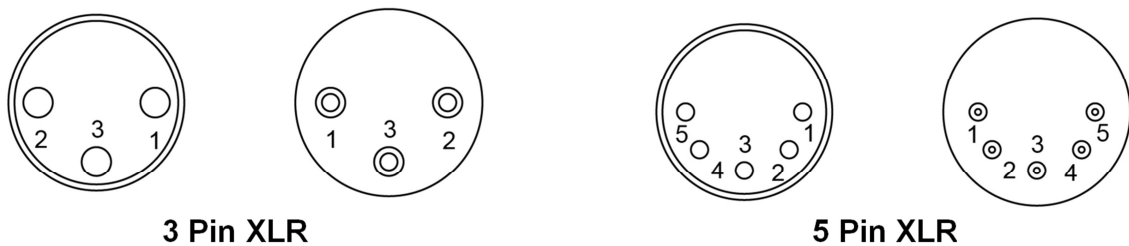

| Pin | Function |
|-----|----------|
| 1 | Ground |
| 2 | Data- |
| 3 | Data+ |

DMX Channel Function

| Channel 1 | DMX Value Range | Function |
|------------------|------------------------|--------------------|
| Fog | 0 – 4 | Fog Off |
| | 5 – 255 | Fog On |
| Channel 2 | DMX Value Range | Function |
| Red LED | 0-255 | 0-100% |
| Channel 3 | DMX Value Range | Function |
| Green LED | 0-255 | 0-100% |
| Channel 4 | DMX Value Range | Function |
| Blue LED | 0-255 | 0-100% |
| Channel 5 | DMX Value Range | Function |
| Amber LED | 0-255 | 0-100% |
| Channel 6 | DMX Value Range | Function |
| Chase | 1-15 | Chase 1 |
| | 16-31 | Chase 2 |
| | 32-47 | Chase 3 |
| | 48-63 | Chase 4 |
| | 64-79 | Chase 5 |
| | 80-95 | Chase 6 |
| | 96-111 | Chase 7 |
| | 112-127 | Chase 8 |
| | 128-143 | Chase 9 |
| | 144-159 | Chase 10 |
| | 160-175 | Chase 11 |
| | 176-191 | Chase 12 |
| | 192-207 | Chase 13 |
| | 208-223 | Chase 14 |
| | 224-255 | Chase 15 |
| Channel 7 | DMX Value Range | Function |
| Chase Speed | 0-255 | 0-255 step per min |
| Channel 8 | DMX Value Range | Function |
| Master Dimmer | 0-255 | 0-100% |
| Channel 9 | DMX Value Range | Function |
| Strobe | 0-255 | 1-20 Hz |

Fluid

Use Antari FLC Water-based Fluid for the best effect for the M-7 RGBA Fogger. The machine is tested and calibrated with this liquid to get the best output performance.

Warranty will be void if any other type of liquid is used, improper use of liquid may lead to machine failure and malfunction.

Service and Maintenance

- Do not allow the machine to become contaminated.
- Remove dust from air vents with air compressor, vacuum or a soft brush.
- Only use a damp cloth to clean the casing.
- Before storing run distilled water through the system to help avoid condensing the pump or heater.
- It is recommended to run the machine on a monthly basis in order to achieve best performance and output condition.
- Excessive dust, liquid and dirt built up will degrade performance and cause overheating.

Breaker Reset



Disconnect AC power before reset breaker. Only replace fuse with same type and rating.

Step 1: Disconnect AC power

Step 2: Flip breaker to ON position

Step 3: Turn on machine to test

Breaker

120V = 15A 250V

230V = 9A 250V



Technical Specifications

| | |
|---------------------|--|
| Input voltage | 120V 60Hz or 230V 50Hz |
| Breaker | 120V = 15A 250V 230V = 9A 250V |
| Heater | 1550W |
| Warm-up time | 5 min. (approx.) |
| Coverage volume | Height 5 Meters, Width 1 Meter |
| Max. operating time | 8 seconds burst |
| Fluid tank capacity | 2.4 L |
| Fluid consumption | 25 ml/10 sec. |
| Recommended Fluid | Antari FLC Water-based Fluid for the best effect |
| Control option | DMX 512, Manual, Timer, Wireless remote |
| DMX channels | 9 channels |
| Power connection | Neutrik Powercon |
| DMX data connection | 3-pin and 5-pin XLR |
| Dimension | L345 x W193 x H385.7 mm |
| Dry weight | 11.5 kg |



C08M07000-RGB